

LED FIXTURE

DL Series



LED Eco-Commercial Strip DL-EC New MW-MK

Linear 4' and 8' LED strip light, 120-347V auto-sensing driver
Multiple Wattage - Multiple Kelvin



5-year limited warranty

Operating temperature range -20 °C ~ +50 °C

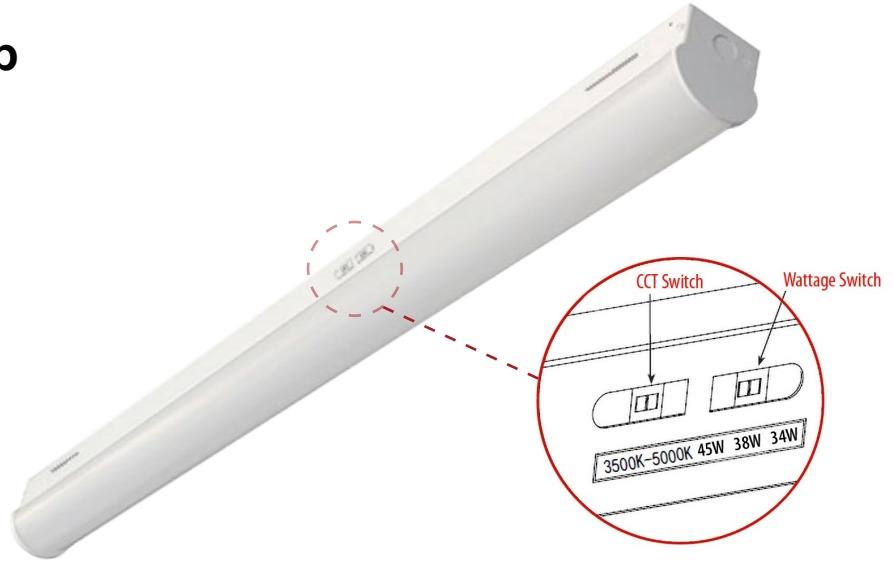

Features & Benefits

- cULus listed, DLC
- Multiple Wattage and Multiple Kelvin (CCT)
- 4' and 8' length selection
- 120-347V Auto-sensing driver, 0-10V dimming
- Average rated life 100,000 hrs L70 (TM-21 @ 70 °C), CRI ≥ 80
- White metal finish, PMMA opal lens
- Surface or suspended mounting, row mountable w/ joiner plate
- Damp location rated

Dimensional Drawing

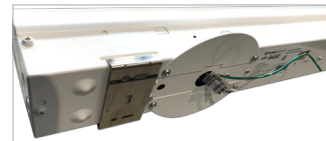
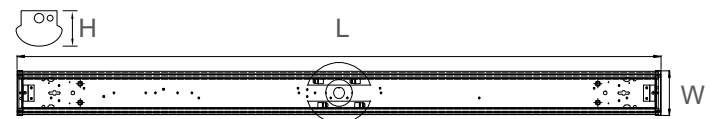

Unique J-Box cover supplied

	L	W	H
4FT	47.3"	3.3"	3.6"
8FT	94.2"	3.3"	3.6"

Ordering Information Example: DL-EC/4F/56W/MK/120-347V/D

Family Name	Fixture Type	Size	Wattage	CCT	Voltage	Dimmable	Sensor	Option
DL (Deltalum)	EC (Eco-Commercial)	4F (4') 4FS (4' Small wattage) 4FL (4' Large wattage) 8FL (8' Large wattage)	56W MW (Multiple wattage)	MK (Multiple CCT)	120-347V	D (Dimmable)	S (Sensor)	RM (Row MTG plate) S (Microwave sensor) TL-2052 PIR sensor DL-EC/MS/CONTROLLER

Product Specification

Ordering Code	DLC	Model Number	Wattage (W)	Input Voltage (V)	Hour Rating (L70)	Beam Angle	Initial Delivered Lumens (lumen)	CCT (K)	CRI	Damp Location	M.O.L (inch)	Case QTY.
3666309	Yes	DL-EC/4F/56W/MK/120-347V/D	56	120-347V	100,000	120°	7448	35-40-50	>80	Yes	48	6
3664306	Yes	DL-EC/4FS/MW/MK/120-347V/D	30-25-18	120-347V	100,000	120°	4050-3250-2340	35-40-50	>80	Yes	48	6
3664307	Yes	DL-EC/4FL/MW/MK/120-347V/D	45-38-34	120-347V	100,000	120°	6075-4940-4420	35-40-50	>80	Yes	48	6
3664308	Yes	DL-EC/8FL/MW/MK/120-347V/D	90-75-65	120-347V	100,000	120°	12150-9750-8450	35-40-50	>80	Yes	96	4
3666310	Yes	DL-EC/4F/56W/MK/120-347V/D/S	56	120-347V	100,000	120°	7448	35-40-50	>80	Yes	48	6
3680307	Yes	DL-EC/4FS/MW/MK/120-347V/D/S	30-25-18	120-347V	100,000	120°	3900-3250-2340	35-40-50	>80	Yes	48	6
3666311	Yes	DL-EC/4FL/MW/MK/120-347V/D/S	45-38-34	120-347V	100,000	120°	6075-4940-4420	35-40-50	>80	Yes	48	6
3666312	Yes	DL-EC/8FL/MW/MK/120-347V/D/S	90-75-65	120-347V	100,000	120°	12150-9750-8450	35-40-50	>80	Yes	96	4
3660057	-	DL-EC/4F/LENS	4ft, replacement white PMMA lens									
3660058	-	DL-EC/8F/LENS	8ft, replacement white PMMA lens									
3660092	-	DL-EC/4F/WG	4ft, wire guard									
3660096	-	DL-EC/RM	Row mounting plate									
-	-	S	Microwave sensor factory installed (consult for lead time)									
3768101	-	TL-2052	PIR motion sensor (sold separately)									
3660097	-	DL-EC/MS/CONTROLLER	Hand held remote control for micro-sensor									

LED Eco-Commercial Strip DL-EC New MW-MK

Microwave Motion Sensor

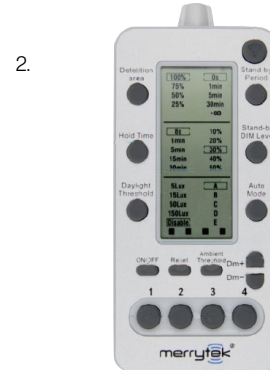

1. Microwave Motion Sensor factory installed.
2. DL-EC/MS/CONTROLLER. The sensor can support the infrared remote control.

Detection Area	100%/75%/50%/25% (Remote Control: 100%/75%/50%/25%)
Hold time	8S/30S/1min/5min/10min/15min/30min (Remote Control: 8S/1min/5min/15min/30min)
Stand-by Period	0S/1min/3min/5min/10min/30min/+∞ (Remote Control: 0S/1min/5min/30min/+∞)
Daylight Sensor	5lux/15Lux/30Lux/50Lux/100lux/150Lux/Disable (Remote Control: 5lux/15Lux/50Lux/150lux/Disable)
Stand-by Dim Level	10%/20%/30%/40% (Remote Control: 10%/20%/30%/40%/50%)
Detection Distance	12m*8m (Max.)

Detection Area	1	2
100%	ON	ON
75%	ON	-
50%	-	ON
25%	-	-

Hold Time	3	4	5
8S	ON	ON	ON
30S	ON	-	ON
1min	-	ON	ON
5min	ON	-	-
10min	-	ON	-
15min	-	-	ON
30min	-	-	-

Stand-by Period	6	7	8
0S	ON	ON	ON
1min	ON	-	ON
3min	-	ON	ON
5min	ON	-	-
10min	-	ON	-
30min	-	-	ON
+ ∞	-	-	-

Stand-by Dim Level	1	2
10%	ON	ON
20%	ON	-
30%	-	ON
40%	-	-

Daylight Sensor	3	4	5	6
5Lux	ON	ON	ON	ON
15Lux	-	ON	ON	ON
30Lux	ON	-	ON	ON
50lux	-	-	ON	ON
100lux	ON	ON	-	ON
150lux	ON	ON	ON	-
Disable	-	-	-	-